

DUDLEY electroflo® taps

Models:



Electroflo Curve
Mains or Battery



Electroflo Curve M
Mains or Battery
(with mixer to adjust
temperature)



Electroflo Linear
Mains or Battery



Electroflo
Contemporary
Mains or battery



Electroflo
Contemporary M
Mains or Battery
(with mixer to adjust
temperature)

Pack Contents

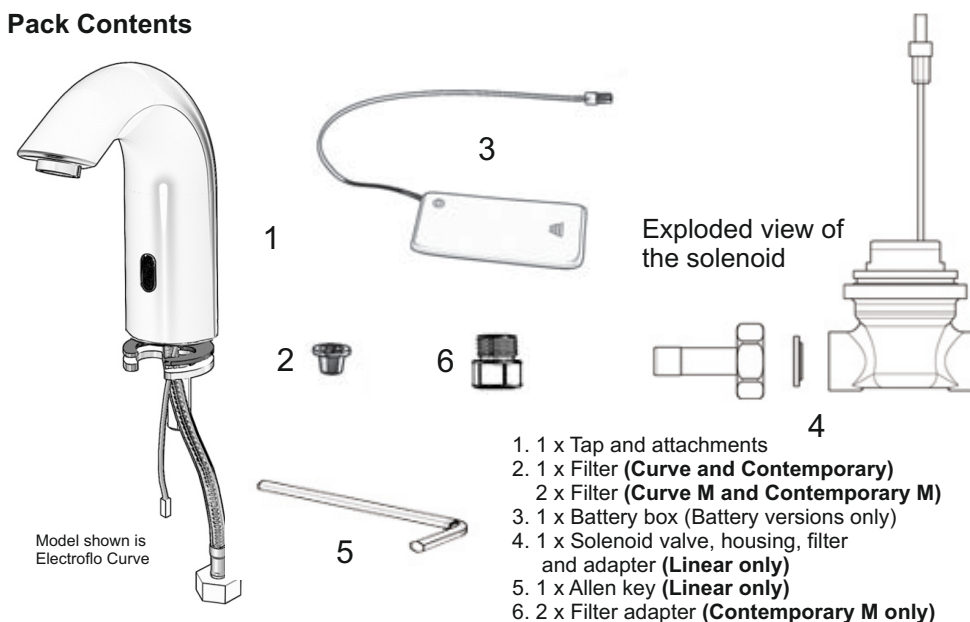

Power supply:
Recommended water pressure:

Preset sensor range:
Minimum sensor range:
Maximum sensor range:
Security time:

9V battery or 9V transformer
0.5-8.0 bar (7-116 PSI) (Linear - 0.3 bar min)
With water pressure of more than 8 bar,
use a pressure reducing valve for reduction
220mm Adjustable
80mm
300mm
90 seconds (Adjustable)



Thomas Dudley Ltd
PLASTIC CISTERN MANUFACTURERS

Dauntless Works, P.O.Box 28, Birmingham New Road,
Dudley, West Midlands, DY1 4SN

Telephone: 0121 530 7000
Fax: 0121 557 5345
E-mail: sales@thomasdudley.co.uk

Pre-installation Information

Check contents

Separate all parts from the packaging and check with the “pack contents” section. Pay attention to the different model variations.

Make sure all parts are accounted for before discarding any packaging material. If any parts are missing, do not attempt to install your electronic tap until you obtain the missing parts.

Warnings

Do not install the tap facing a mirror or any other electronic system operated by an infra-red sensor.

To prevent reflection problems, it is recommended to keep a minimum distance of 1.5 metres between the tap and any other objects.

Preparation for installation

Flush water supply lines thoroughly before installing the tap. **Do not allow dirt, PTFE tape or metal particles to enter the tap.**

Important - Plumbing must be installed in accordance with applicable codes and regulations. Installation of the mains adaptor must be carried out and checked by a qualified electrician. During installation do not expose the electronics to fluids, dust, dirt or damp.

Tap Installation

Step 1 – Remove all mounting hardware

1. Remove the hexagonal nut, the washer and the gasket. Do not remove the O-ring from the base of the tap.

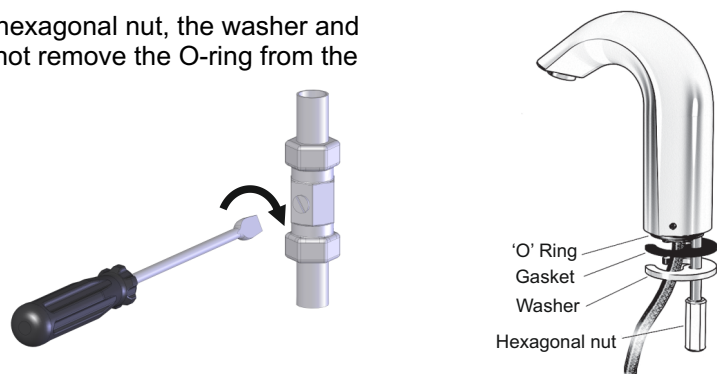

Step 2 - Installing the tap

1. Place the tap with the O-ring into the hole in the basin or cut a 30mm hole in the work top. Make sure the O-ring is located between the work top/basin and the bottom of the tap.

2. Secure tap to the work top or basin with the washer and hexagonal nut ensuring no pipes or wires are trapped.



Check the water supply pressure. It must be 0.5 - 8 bar (7 - 116 PSI). For water pressures above 8 bar, use a pressure reducing valve. Check sensor is not in Security Mode. If the sensor is covered for more than 90 seconds the tap will automatically shut off water supply. To return to normal operation remove any blockage.

Water flow does not stop: Check the diaphragm. If necessary, clean the orifice or replace it. Check the solenoid valve. If debris or scale are present, unscrew the solenoid valve, pull out the plunger and the spring and clean them. Use scale remover if necessary. When replacing the spring, make sure that it is in the vertical position. Ensure sensor is not picking up any reflections. Ensure sensor is not dirty or covered. Check the batteries and replace if necessary. Check all connections and ensure power supply is correctly connected.

Water flow diminished: Check the filter and aerator and if necessary remove, clean and reinstall.

Maintenance

Filter Cleaning Instructions

This tap is provided with a stainless steel filter to prevent foreign particles from entering the tap. If the water flow has decreased, this can be because the filter is clogged. The filter can be cleaned as follows:

1. Turn-off the water shut-off valve.
2. Disconnect the flexible pipe.
3. Remove the filter and wash under running water.
4. Reassemble the parts.
5. Turn on the water supply and make sure that there is no water leakage.

Care and Cleaning of Chrome and Special Finishes.

DO NOT use steel wool or cleansing agents containing alcohol, acid, abrasives, or the like. Use of any prohibited cleaning or maintenance products or substances could damage the surface of the tap.

For surface cleaning of the tap use **ONLY** soap and water, then wipe dry with a clean cloth or towel. When cleaning bathroom tiles, the taps should be protected from any splattering of harsh cleansers.

Battery Replacement Instructions

Battery models only

When the battery weakens, the red indicator light will blink at a constant rate. The battery must be replaced within 2 weeks.

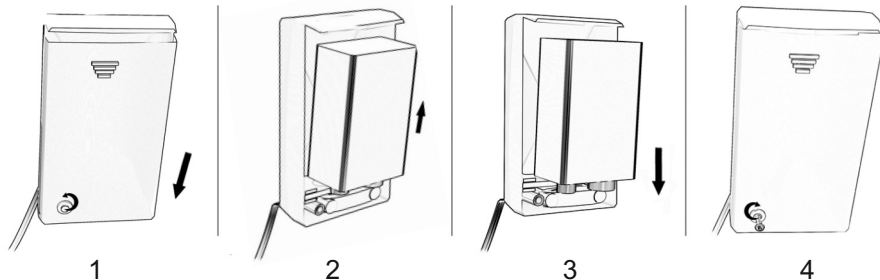

1. Remove the screw and carefully open the battery box.
2. Remove the old battery.
3. Replace the used battery with a new 9V battery (Lithium battery is recommended).
4. Close the box and replace the screw.

Trouble Shooting

No water is coming out of the tap:

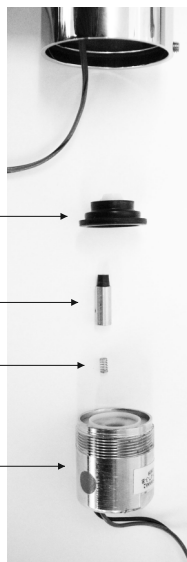

Check the batteries and replace if necessary.

Ensure sensor is not picking up reflections from a mirror or any other object.

Check the sensor range - If range is too short or too long, increase or decrease the range.

Check all connections and ensure power supply is correctly connected.

Check the solenoid valve. If debris or scale are present, unscrew the solenoid valve, pull out the plunger and the spring and clean them. Use scale remover if necessary. When replacing the spring, make sure that it is in the vertical position.

Check the diaphragm. If necessary, clean the orifice or replace it

Step 3.1 – Connecting the water supply for Curve and Contemporary

1. Turn off the mains water supply.

2. Make sure that the filter/s and filter adapters (contemporary M only) are installed in the correct orientation between the flexible pipe and the shut off valve (not supplied).

3. Connect the flexible pipe to the water supply.
For Curve M and Contemporary M connect the red flexible pipe to the hot water supply and the blue flexible pipe to the cold water supply.

4. Turn on the mains water supply and check for leaks.

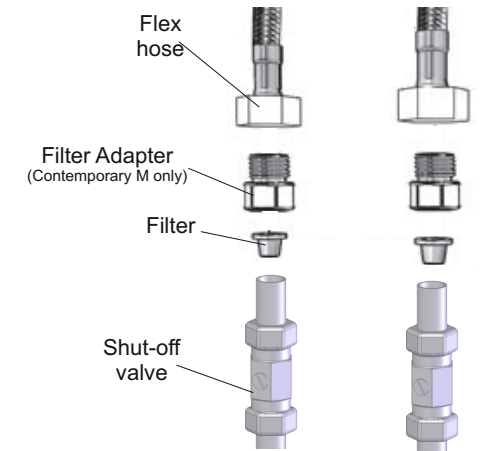

Note: Dual pipework required for Curve M and Contemporary M only

Step 3.3 – Connecting the water supply for Linear

1. Turn off mains water supply

2. Fit the pipe to the housing of the solenoid valve.
Important: inlet and outlet should follow the indicating arrow on the solenoid housing.

3. Fit the supply inlet to the adapter on the solenoid valve housing.

4. Turn on the mains water supply and check for leaks.

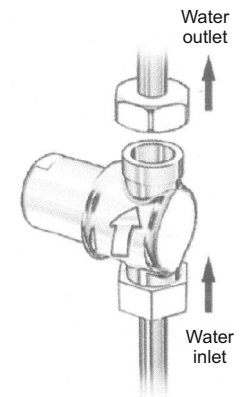

Step 4 – Connecting the power source

1. Either connect the transformer or install the battery box underneath the sink using double sided adhesive tape with the cable exiting from the base (You can use an optional extension cable in order to assemble the battery box up to 10ft. away from the sink).

2. Wait a few seconds before activating the tap.

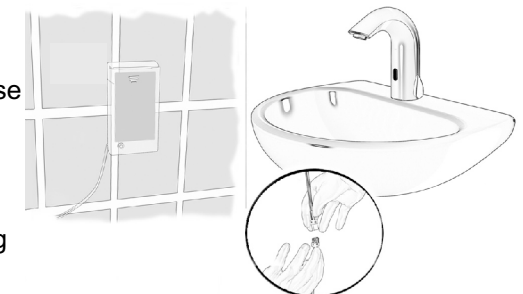

Range Adjustment

The sensor range is the distance an object can be away from the sensor in order to activate the tap. The sensor is factory preset. If necessary, it can be adjusted as follows:

Adjusting the sensor range:

1. Disconnect the power supply, battery or transformer, from the sensor.

2. Make a short circuit between the (+) and the (-) of the sensor. Alternatively, after disconnecting the power supply, activate the sensor 3 or 4 times.

Do not make a short circuit on the power supply or on the sensor when the power supply is connected to the sensor.

3. Reconnect the power supply to the sensor.

4. To enter the adjusting mode, put your hand in front of the sensor at a distance of 5cm (2") to 10cm (4") within 5 seconds after the reconnection of the power supply. **Note:** If you do not put your hand in front of the sensor after connecting the power supply, the sensor will not enter the adjusting mode and the previous setting will return.

5. When the sensor enters the adjusting mode and your hand is in front of the sensor, a slow flashing red light at the front of the sensor will occur.

6. Keep your hand in front of the sensor until the slow flashing changes to quick flashing. At this point move your hand to the required distance from the sensor and wait until the red light stops flashing.

7. When the red light has turned off, your sensor has been adjusted to the required distance.

8. Check the distance you have set and if it is not satisfactory repeat steps 1-6.

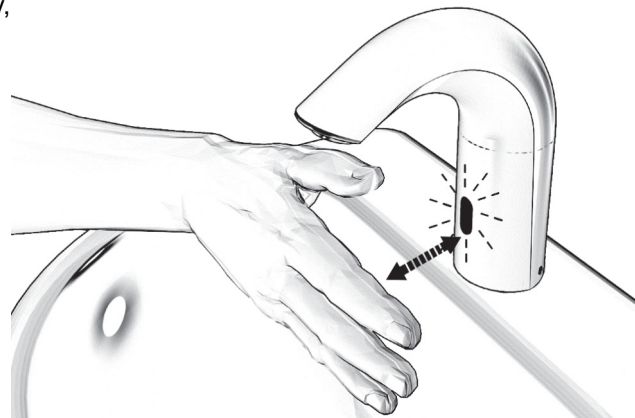
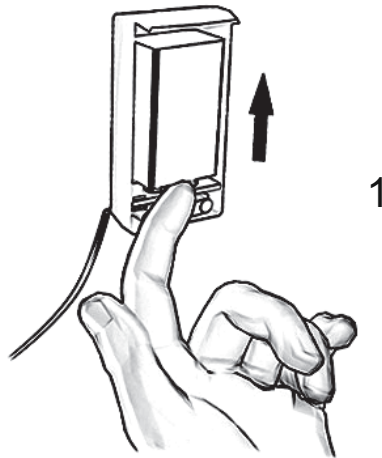

Range Adjustment using Remote Control - optional and recommended

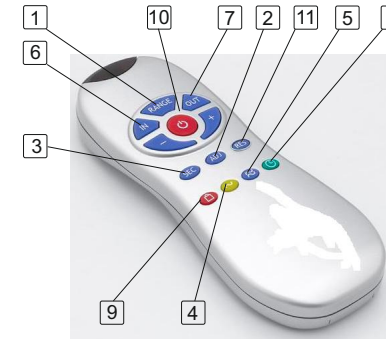

If necessary, use the remote control to adjust the sensor range as follows:

Hold the remote control straight in front of the sensor about 10cm (4"). Choose the function you want to adjust by pressing once one of the function buttons. After pressing on a specific function button, a quick flashing of the red light at the front of the sensor will occur. At this stage adjustments can be made by pressing the (+) or (-) buttons. Every push will increase or decrease one level.

- 1 DETECTION RANGE - One press of either +/- gives an increase / decrease of 10mm in range up to a maximum of 450mm (Curve and Contemporary) 400 mm (Linear) and minimum of 110 mm (Curve and Contemporary) 120mm (Linear).
- 2 MANUAL RANGE ADJUSTMENT: Allows the user to adjust the range by using a hand to indicate the distance. Press the ADJ button, the sensor light will flash, place a hand at the desired distance. Adjustment is complete when the light stops flashing.
- 3 SECURITY TIME: This is to combat vandalism. If the sensor is covered for more than 90 seconds it will shut off. 20 presses will reduce the time to a minimum of 30 seconds
- 4 FLOW TIME: N/a with taps.
- 5 FLOW TIME 2: N/a with taps.
- 6 DELAY IN TIME: N/a with taps.
- 7 DELAY OUT TIME: Determines the delay time after the user has removed their hands from under the tap. 1 press increases / decreases the time by 3 seconds
- 8 24 HOUR HYGIENE FLUSH: Provides a timed flush of 24 hours to keep the tap clear from water borne diseases and to stop freezing.
- 9 LOCK OUT: N/a
- 10 TEMPORARY OFF FUNCTION: Turns off the flush for one minute to allow for cleaning etc. To cancel the command, press the button again or wait 1-2 minutes
- 11 RESET BUTTON: Allows the user to return to factory preset options. Press the reset and + simultaneously.

Adjusting the Aerator

This tap includes a special aerator that allows you to adjust the water stream direction on site in order to prevent water splashing if needed. To change the angle of the water stream, simply move the adjustable tilting plate by pressing it.

